

TOTAL JOINERY SUPPLIES

CUSTOM BUILT RESIDENTIAL AND COMMERCIAL JOINERY

ADD: 1/71 NORTHGATE DRIVE THOMASTOWN
 PH: (03) 94645111 FAX: (03) 9464 5145
 EMAIL: TOTALDESIGN1@BIGPOND.COM
 WEB: WWW.TOTALJOINERYSUPPLIES.COM.AU

SHAKER VANITIES

AVAILABLE SIZES (ISOMETRIC VIEW):

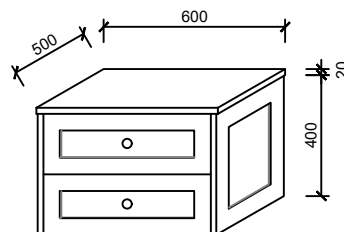

2DR600

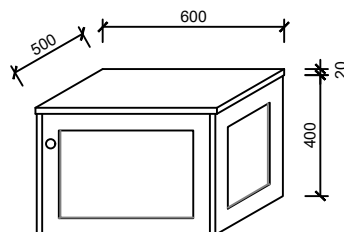

1DO600

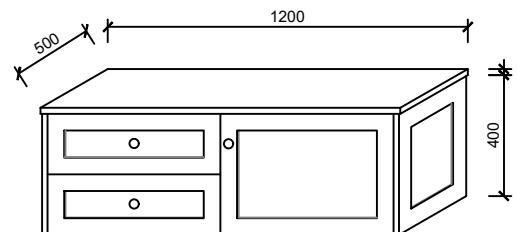

2DR1DO600

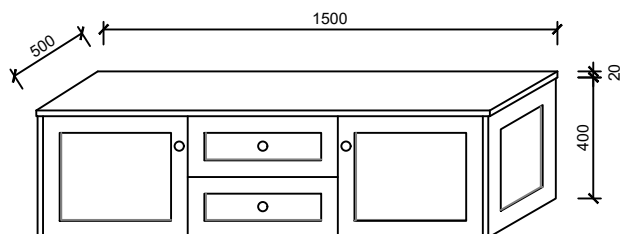

1DO2DR1DO500

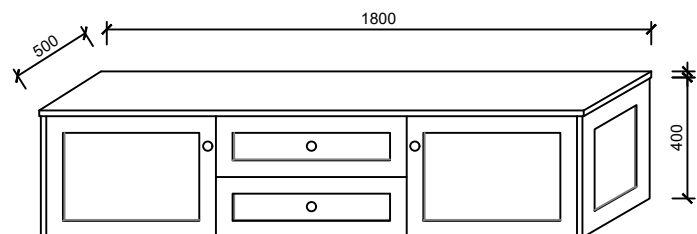

1DO2DR1DO600

AVAILABLE SIZES (TEXT):

- 2DR600 = 600MM OVERALL
- 2DO600 = 600MM OVERALL
- 2DR1DO600 = 1200MM OVERALL
- 1DO2DR1DO500 = 1500MM OVERALL
- 1DO2DR1DO600 = 1800MM OVERALL

SPECIFICATION:

- CARCASS (W): 16MM WHITE MELAMINE
- CARCASS (B): 16MM BLACK MELAMINE
- DRAWER FACES: 18MM 2PAC SHAKER
- BENCHTOP (20): 20MM STONE / TIMBER
- BENCHTOP (32): 32MM SOLID TIMBER
- HARDWARE: BLUM ANTARO
- HANDLES: MUSHROOM KNOB

INSTALLATION INSTRUCTIONS:

INSTALLATION MUST BE PERFORMED BY QUALIFIED PERSONNEL. ENSURE UNIT DOES NOT BUTT INTO WET AREAS, LEAVE MINIMUM 100MM. ENSURE UNIT IS NOT EXPOSED TO SHOWER SPRAY. ENSURE ROOM IS ADEQUATELY VENTILATED. CONSIDER DIRECT SUNLIGHT (THIS MAY CAUSE UNIT TO FADE OVER TIME). FIX UNIT DIRECT TO STUD WITH ONLY PLASTER OR CEMENT SHEET BETWEEN. DO NOT FIX TO TILES. ENSURE TOP AND BOTTOM FIXING TO EACH STUD. MINIMUM FIXING OF 2 STUDS FOR FIRST 600MM. FIX TO EVERY STUD AFTER 600MM AT MINIMUM OF 450MM CENTERS. CREATE ADDITIONAL SUPPORT IF EXISTING WALL CANNOT ACHIEVE REQUIRED SUPPORT. ENSURE WALL IS PLUMB, STRAIGHT AND LEVEL. ENSURE WASTE PIPE IS LOCATED BETWEEN THE CUT-OUT PROVISION. INSTALLER IS RESPONSIBLE FOR CORRECT INSTALLATION AND DRAWER FACE ALIGNMENT.

WARRANTY:

- 7 YEARS MANUFACTURERS WARRANTY
- WARRANTY INCLUDES REPLACEMENT OF FAILED HARDWARE OR DEFECTIVE JOINERY
- FAIR WEAR AND TEAR EXCLUDED
- WATER DAMAGE EXCLUDED
- DAMAGE/FAILURE DUE TO INCORRECT INSTALLATION OR INCORRECT USE OF PRODUCT EXCLUDED